

**NEW** model



CNC SWISS TYPE AUTOMATIC LATHE

# SR-38J

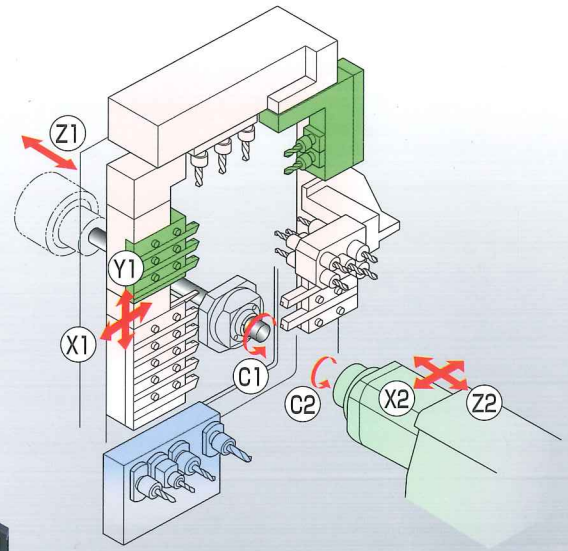

Illustration of tool post :  
3-tool holder type with a cartridge position extension unit

※ Large coolant tank type



## Large Diameter

# SR-38J, The Model Focused on the Basic Performance of Multi-Processing

Taking aim at the multi-processing of large diameter workpieces, SR-38J comes with selected functions to meet various process needs with scalability.

### Functions and Processing Capabilities

#### Portal-Type Tool Post for Extendable Tool Mounting Capacity

The portal-type tool post gives high extensibility of mountable tools for front-side machining to facilitate flexible tooling.

#### Extendable Cartridge Position

Mounting various tool units enables multiple processes such as cross-milling, front-drilling, and polygon machining. An optional cartridge position extension unit (2 positions) allows even more advanced tooling configuration such as slotting or thread whirling (see below).

#### Hydraulic Main Spindle Chuck

TA rotary cylinder ensures stable gripping force for main spindle collet opening and closing.

#### G.B. and N.G.B. Switchability for Various Shape of Workpieces

Switching between guide bush (G.B.) and non-guide bush (N.G.B.) modes facilitates machining optimization for various length of workpieces.

### High Rigidity and High Accuracy

#### Spindle Head Slide Guideway Structure for High Rigidity

Non-guide bush mode utilizes the spindle head slide guideway structure to ensure the rigidity of the main spindle.

#### Built-in Spindles for High Indexing Accuracy

Both the main and sub spindles each use a built-in motor to improve indexing accuracy.

### Operability and Workability

#### Movable Control Panel for Good Operability

A movable control panel facilitates operation at the optimum position all the time.

#### Flip-up Doors to Provide Sufficient Work Space

The headstock chamber and cutting chamber use flip-up doors to provide wide opening and ample workspace.

## Extendable Tooling Configuration

- 1 Basic Configuration
- 2 1 + 3-Tool Holder + Tool Unit A (1 cartridge position)
- 3 1 + 3-Tool Holder + Cartridge Position Extension Unit(2 cartridge positions) + Tool Unit A & B

#### \* Tool Unit A

Milling Unit, 2-spindle Opposing Type Face Drilling Unit, Polygon Machining Unit, 2-spindle Sleeve Holder

#### \* Tool Unit B

Slotting Unit, Thread Whirling Unit

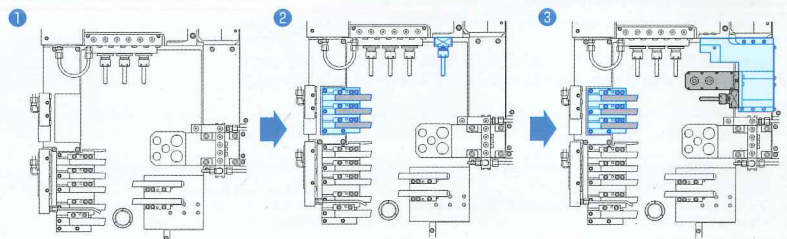

● Mounting slotting unit and thread whirling unit requires the cartridge position extension unit.



## □ Standard Machine Specifications

OP : Option

Item		Specifications
Max. machining diameter	Standard	φ38mm(1-1/2in)
	Non-guide bush type	φ42mm (1-21/32in)
Max. headstock stroke	Standard	320mm(12-19/32in)
	With R.M.G.B. unit	288mm(11/32in) : OP
	Non-guide bush type	Bar diameter×2.5(Max.95mm)(Max.3-47/64in) : OP
Tool	5 tools on the front+2 tools on the rear+3 tools on the front : OP	
5-Spindle sleeve holder	Number of tools	Front 5 tools Rear 5 tools
	Max. drilling capability	φ23mm(29/32in)
	Max. tapping capability	M16×P2.0
Power driven attachment	Number of tools	Cross milling : 3 tools Cartridge type : At 1 position
	Max. drilling capability	φ10mm(25/64in)
	Max. tapping capability	M8×P1.25
	Spindle speed	Max.6,000min <sup>-1</sup>
	Drive motor	2.2kW(continuous) / 3.0kW(5min./30%ED)
Rapid feed rate	36m/min(X1,Y1,Z1,X2,Z2)	
Main spindle indexing angle	C-axis control	
Main spindle speed	Max.7,000min <sup>-1</sup>	
Main spindle motor	7.5kW(continuous) / 11kW(10min./25%ED)	
Coolant tank capability	253 ℓ (359 ℓ : OP)	
Dimensions (WxDxH)	2,740×1,315×2,120mm	
Weight	4,250kg	
Power consumption	12.8kVA	
A-weighted sound pressure : <b>note-1</b>	Max.74.0dB	

## □ Backworking Attachment Specifications

Item		Specifications
Max. chucking diameter		φ38mm(1-1/2in)
Max. length for front ejection		150mm(5-7/8in)
Max. parts projection length		70mm(2-3/4in)
Number of tools		4 tools
Back 4-Spindle unit	Max. drilling capability	Stationary tool φ14mm(35/64in) Power driven tool 8 mm(5/16in)
	Max. tapping capability	Stationary tool M12×P1.75 Power driven tool M6×P1.0
Power-driven att. drive motor		1.0kW(continuous) / 1.2kW(5min./30%ED)
Sub spindle indexing angle		C-axis control
Sub spindle speed		Max.7,000min <sup>-1</sup>
Sub spindle motor		3.7kW(continuous) / 5.5kW(10min./40%ED)

## □ External Dimensions

Unit : mm(ft)

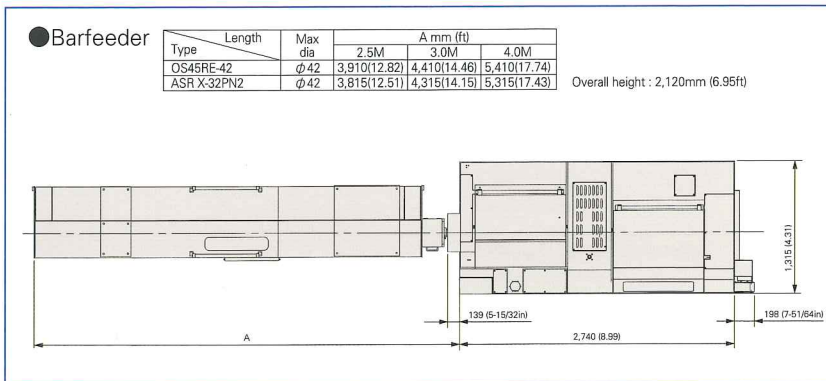

※Design features, specifications and technical execution are subject to change without prior notice.

※This product is an export control item subject to the foreign exchange and foreign trade laws. Thus, before exporting this product, or taking it overseas, contact your STAR MICRONICS dealer.

# STAR MICRONICS CO., LTD.

## Machine Tools Division

1500-34 Kitanoya, Misawa, Kikugawa, Shizuoka, 439-0023 Japan

America, Europe Sales TEL.+81-537-36-5594 FAX.+81-537-36-5607  
Asia Sales TEL.+81-537-36-5574 FAX.+81-537-36-5607

### Star CNC Machine Tool Corporation

123 Powerhouse Road, Roslyn Heights, NY11577, U.S.A.  
TEL.+1-516-484-0500 FAX.+1-516-484-5820

### Star Micronics GB Limited

Unit 1 Riverlands Business Park Raynesway DERBY DE21 7BZ  
TEL.+44-1332-86-44-55 FAX.+44-1332-86-40-05

### Star Micronics GmbH

Robert-Grob-Str.1, D-75305 Neuenbürg, Germany  
TEL.+49-7082-7920-0 FAX.+49-7082-7920-20

### Star Micronics AG

Lauetstrasse3, CH-8112 Otelfingen, Switzerland  
TEL.+41-43-411-60-60 FAX.+41-43-411-60-66

### Star Machine Tool France

90 Allée de Glaisy, ZI 74300 Thyez Haute Savoie, France  
TEL.+33-450-96-05-97 FAX.+33-450-96-91-54

### Shanghai Xingang Machinery Co., Ltd.

2F, 229 Fute Rd.N. The China (Shanghai) Pilot Free Trade Zone  
TEL.+86-21-5868-2100 FAX.+86-21-5868-2101

### Star Micronics (Thailand) Co., Ltd.

289/23 M.13 Sol Kingkaew 25/1, Kingkaew Rd., T.Rachathewa A.Bangplee Samutprakarn 10540, Thailand  
TEL.+66-2-186-8945-47 FAX.+66-2-183-7845

## □ Standard Accessories and Functions

- CNC unit FANUC 0i-TF
- Operation panel 10.4-inch color LCD display
- Manual pulse generator
- Pneumatic unit
- Hydraulic unit
- Automatic centralized lubrication unit
- Coolant level detector
- Door interlock system
- Broken cutoff tool detector
- Drive unit for revolving guide bush
- Revolving guide bush unit
- Air purge unit for revolving guide bush
- Main/Sub collet
- Spindle clamp unit (main/sub)
- 5-station tool holder □16/20mm
- 2 tool holder □16mm
- 5-spindle sleeve holder
- Drive unit for power-driven  
(Gang type tool post : Including 3 cross milling tools)
- Cs contouring control (Main / Sub)
- Spindle cooling unit
- Air purge unit for sub spindle
- Back 4-Spindle unit
- Work light
- Leakage breaker

## □ Optional Accessories and Functions

- Coolant flow detector
- Parts ejection detector
- Water removal unit
- Oil mist filter
- Beacon
- Chip conveyor
- Rotary magic guide bush unit
- For pneumatic unit rotary magic guide bush
- Non-guide bush type
- Main spindle inner tube
- Parts ejector (Air cylinder type)
- Parts ejector (Spring type)
- Parts ejector with guide tube
- Parts stopper unit
- Parts conveyor
- Drive unit for power-driven B (4-spindle backworking unit)
- Coolant tank large capacity type
- Coolant unit (6.9MPa / 2.5MPa / 0.7MPa)
- Coolant unit signal cable
- Coolant unit power cable
- Coolant valve (6.9MPa / 2.5MPa)
- Coolant pipings
- Coolant cooling unit
- Automatic bar feeder interface
- Compliant with the RS-232C interface
- LAN interface
- Transformer CE marking version
- Transformer CE marking cable
- CE marking version

### Note)

The machining capacities apply to SUS303 material. The machining capacities may differ from listed values depending on the machining conditions, such as the material to be machined or the tools to be used.

**note-1** : ● Measures conforming to ISO standard.

● A-weighted sound pressure is a general assessment standard characteristic that corrected the sound level to human acoustic sense.

**9001 ISO 14001**  
CERTIFIED

<http://www.star-m.jp/eng/>

2018.10\_Ver1.0\_1